

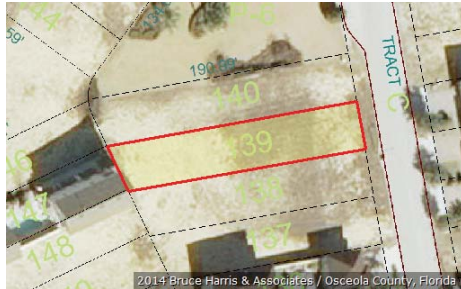

Katrina S. Scarborough, CFA, CCF, MCF
 Osceola County Property Appraiser
 www.property-appraiser.org
 Osceola County Government Center
 2505 East Irló Bronson Memorial Hwy, Kissimmee, FL 34744
 Ph: (407) 742-5000 Fax:(407) 742-4900

Parcel: 35-25-27-4838-0001-1390



Owner Information

Owner Name	TAINO-TI II LLC
Mailing Address	15013 MEADOWLAKE ST ODESSA, FL 33556
Physical Address	7629 EXCITEMENT DR, KISSIMMEE
Description	VACANT
Tax District	300 - OSCEOLA COUNTY

Tax Values

Current Values		Certified Values	
Current Value represents working appraised values as of 01/11/2014, which are subject to change prior to certification		Certified Value represents certified values that appeared on the tax roll as of 10/04/2013	
Land	\$25,200	Land	\$25,200
AG Benefit	\$0	AG Benefit	\$0
Extra Features	\$0	Extra Features	\$0
Buildings	\$0	Buildings	\$0
Appraised(just)	\$25,200	Appraised(just)	\$25,200
Assessed(estimated)	\$25,200	Assessed*	\$18,480
Exemption(estimated)	\$0	Exemption	\$0
Taxable(estimated)	\$25,200	Taxable	\$18,480
* Assessed Values Reflect Adjustments for Agricultural Classification and/or the Save Our Homes Cap		* Assessed Values Reflect Adjustments for Agricultural Classification and/or the Save Our Homes Cap	

Sales Information

Seq	ORB-Pg	Price	Date	Deed Type
0	4538-2028	\$37,000	2013-11-21	WD
1	4459-2971	\$100	2013-06-06	SW
2	4459-2967	\$100	2013-05-31	SW
3	4428-1308	\$100	2013-04-16	CT
4	2889-0502	\$220,000	2005-08-15	WD
5	2035-1813	\$64,000	2002-04-28	SW

Land Information - Total Acreage: 0.14

Land Description	Units	Depth	Land Type	Land Value
COTTAGE	0.00	178	LT	\$25,200

Legal Description

Legal Description REUNION PHASE 2 PARCEL 1 AND 1A PB 13 PGS 115-123 LOT 139